

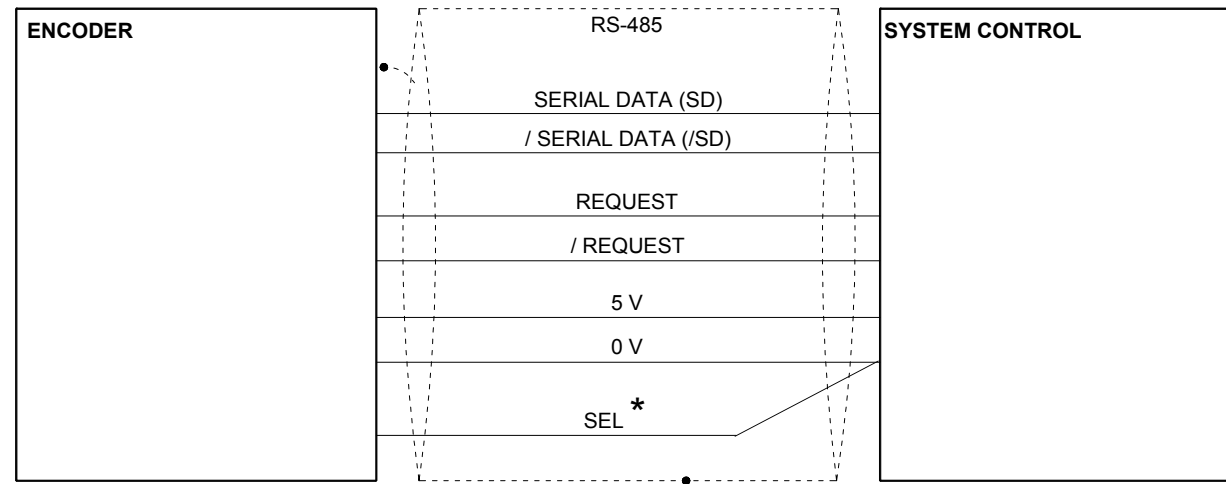

LAM



* La comunicación por defecto es full duplex.
Full duplex is the default communication.
Para comunicación half duplex contactar con Fagor.
Contact Fagor for half duplex communication.

Características eléctricas / Electrical characteristics

	LAM	LAM50	LAM10
Resolución / Resolution	100 nm	50 nm	10 nm
Alimentación / Power supply	5 V ± 10% 250 mA		
Conexión / Connection	Con conector incorporado With built-in connector		
Máxima longitud de cable Maximum cable length	30 m / 100 feet		

MITSUBISHI: CONEXIONES / CONNECTIONS

EC...AM...MB :

Cable para **conexión directa** a sistemas absolutos MITSUBISHI full duplex. Con ferrita. Disponible en 1, 3, 6 and 9 metros.
Cable for **direct connection** to full-duplex MITSUBISHI absolute systems. With ferrite. Available in 1, 3, 6 and 9 meters.



EC - ...AM - MB

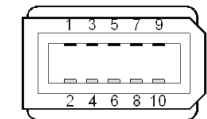

PIN	7	8	3	4	1	2	Carcasa / Housing
SEÑAL SIGNAL	SD	/SD	REQ	/REQ	+5V	0V	Tierra / Ground
COLOR	Verde Green	Amarillo Yellow	Gris Grey	Rosa Pink	Marrón + Violeta Brown + Purple	Blanco+Negro+Azul White+Black+Blue	Malla / Shield

Alargaderas / Extension cables

CABLE		EXTENSION CABLE / ALARGADERA			TOTAL LENGTH LONGITUD TOTAL
Reference	Connector	Connector	Reference	Connector	
EC-1B-C9-F	C9	C8	XC-C8-x-MB	Mitsubishi	* 30 m
EC-1B-C9-N-F	Round 17-PM/RM	Round 17-PH/RH	XC-C8-x-F-C9	C9-Round 17-PM/RM	

Round = Circular, PM = Male pins; RM = Male thread, PH = Female pins, RH = Female thread, M = Male, H = Female
PM = Pines macho, RM = Rosca Macho, PH = Pines hembra, RH = Rosca hembra, M= Macho, H = Hembra

También se puede utilizar la combinación de un cable EC...B...C9-F con una alargadera XC...C8...MB para otras longitudes.
A combination of EC...B...C9-F cable and an XC...C8...MB extension cable may be used for other lengths.

EC...B...C9-F Cable disponible en 1 y 3 metros con ferrita. Contactar con FAGOR para otras longitudes.
Cable available in 1 and 3 meters with ferrite. Contact FAGOR for other lengths.

Conector (C9) macho circular 17 male connector

PIN	14	17	8	9	7	1	10	4	Caperuza Housing
SEÑAL SIGNAL	REQ	/REQ	SD	/SD	+5V	+5V sensor	0V	0V sensor	Tierra Ground
COLOR	Gris Grey	Rosa Pink	Negro Black	Violeta Purple	Marrón Brown	Verde claro Light green	Blanco White	Naranja Orange	Malla externa External shield

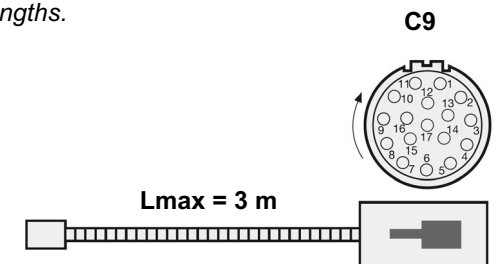

XC...C8...MB

Alargadera para conexión directa a sistemas absolutos MITSUBISHI full duplex.
Disponibile en 5, 10, 15, 20 y 25 metros.
Extension cable for direct connection to MITSUBISHI full-duplex absolute systems.
Available in 5, 10, 15, 20 and 25 meters.

Conector (C8) hembra circular 17 female connector

PIN	8	9	14	17	7	1	10	4	12	Caperuza Housing
-----	---	---	----	----	---	---	----	---	----	---------------------

Conector (MB) hembra rectangular female rectangular connector

PIN	7	8	3	4	1	1	2	2	2	16
SEÑAL SIGNAL	SD	/SD	REQ	/REQ	+5V	+5V Sensor	0V	0V sensor	SEL	Tierra Ground
COLOR	Gris Grey	Rosa Pink	Violeta Purple	Amarillo Yellow	Marrón-verde Brown-green	Azul Blue	Blanco-verde White-green	Blanco White	Negro Black	Malla Shield

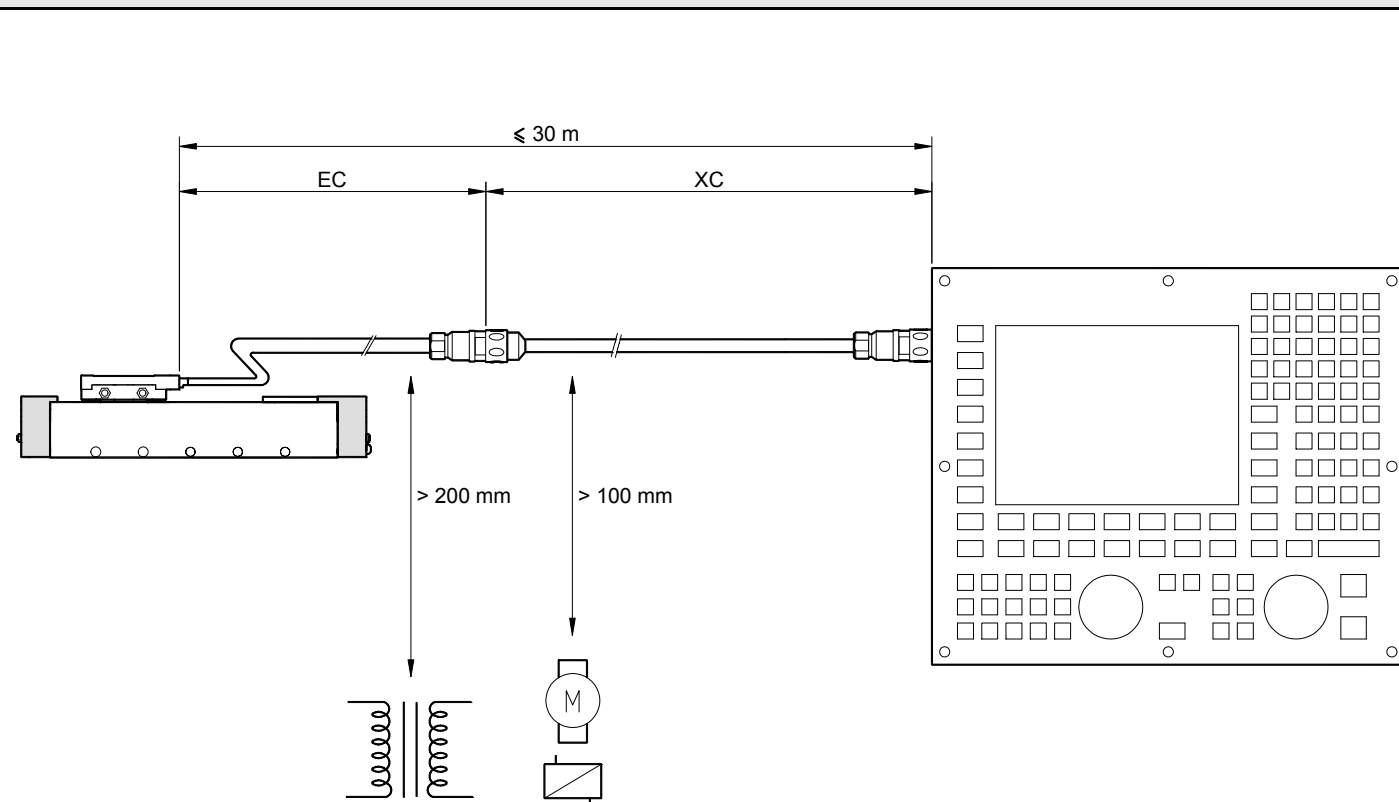
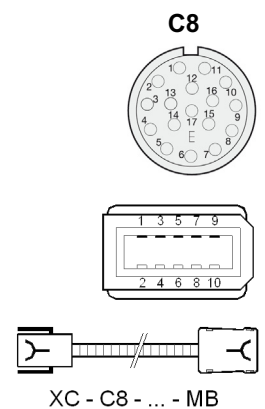

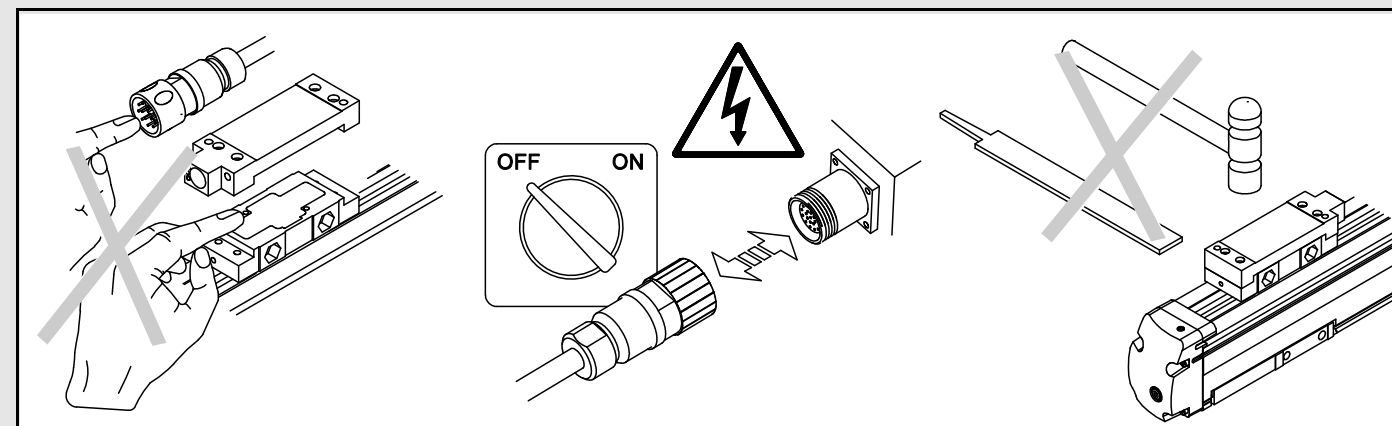

Es posible orientar la salida del conector a ambos lados.
The connector exit may be oriented at both ends.

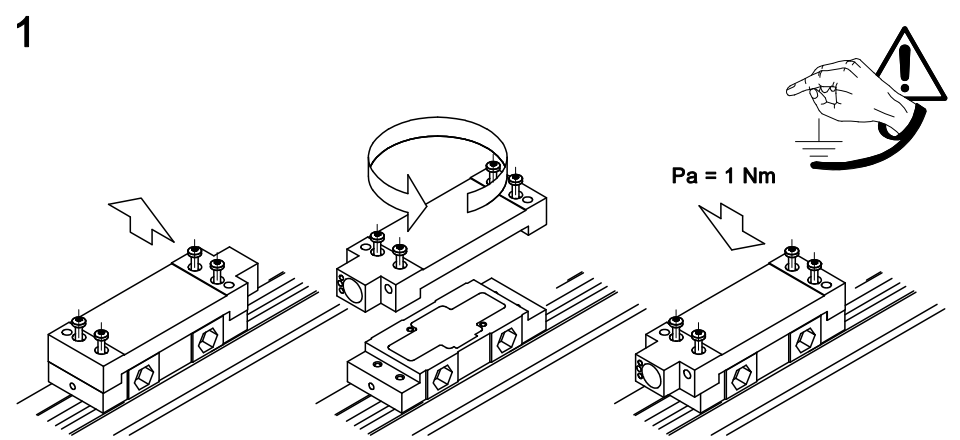

Introducir la cabeza por cualquiera de los dos extremos de la regla.
Insert the reader head through any of the two ends of the scale.

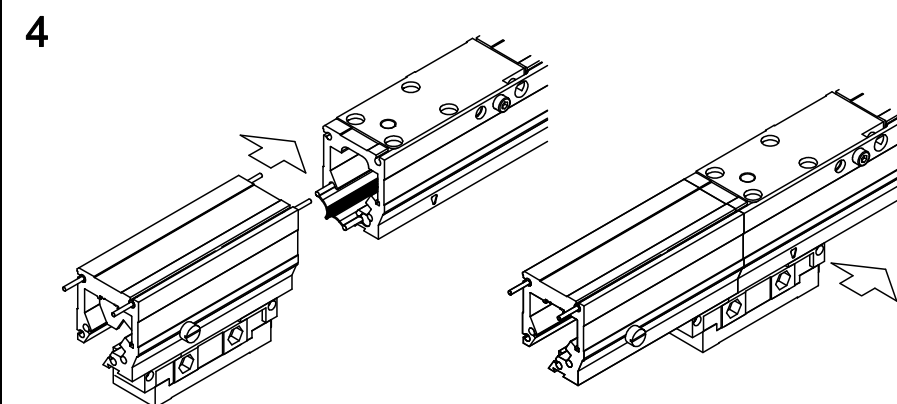

Quitar las tapas.
Remove the end caps.

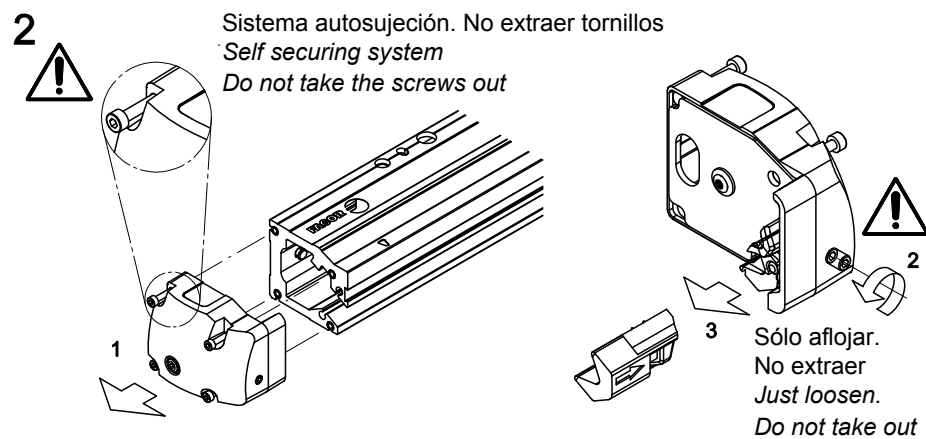

Fijar la cabeza lectora.
 Los soportes fijan la distancia de separación (2.5 mm) entre la cabeza y la regla.
 Quitar los soportes de la cabeza.
Secure the reader head. The supports set the 2.5 mm gap between the reader head and the scale. Remove the reader head supports.

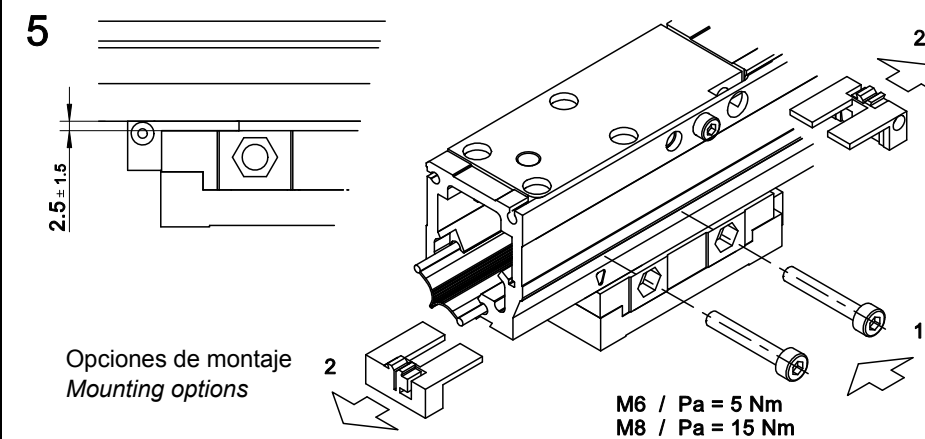

Aflojar los tornillos del embalaje de la cabeza.
Loosen the packing screws of the reader head.

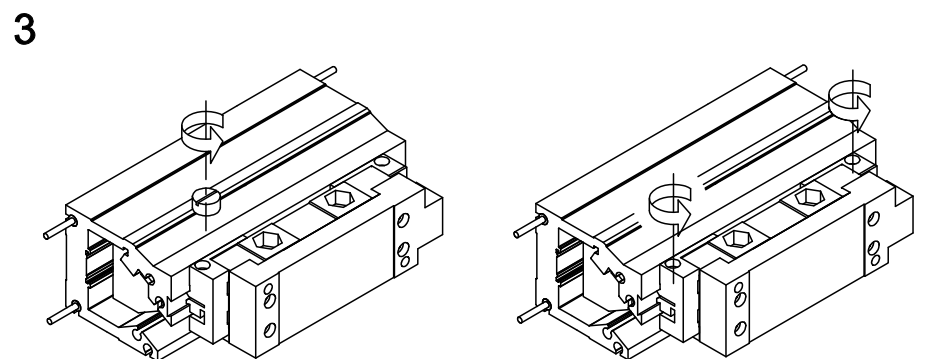

Poner las tapas.
Mount the end caps.

